



WORKHOLDING AND AUTOMATION

Permanent Magnetic Chuck

SAV 243.12

With transverse pole pitch, $P = 13$ mm, enhanced holding force

Use:

Heavy machining, such as milling and planing. The low magnetic field prevents the magnetization of the cutting tools. ON-OFF control by means of hand lever. Options include safety circuitry with a proximity switch, as well as longitudinal and transverse end stops.

Suitable for use with laminated topplates:
SAV 248.02 and SAV 248.03
(see chapter 06).

Features:

Double magnet arrangement in stable cast iron housing.

Laminations: 5 mm brass / 8 mm steel

Nominal holding force: 140 N/cm²
Magnetic field height: ca.10 mm
Pole plate wearing limit: 7 mm

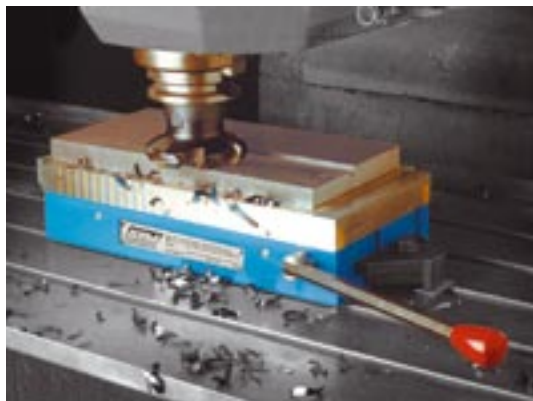
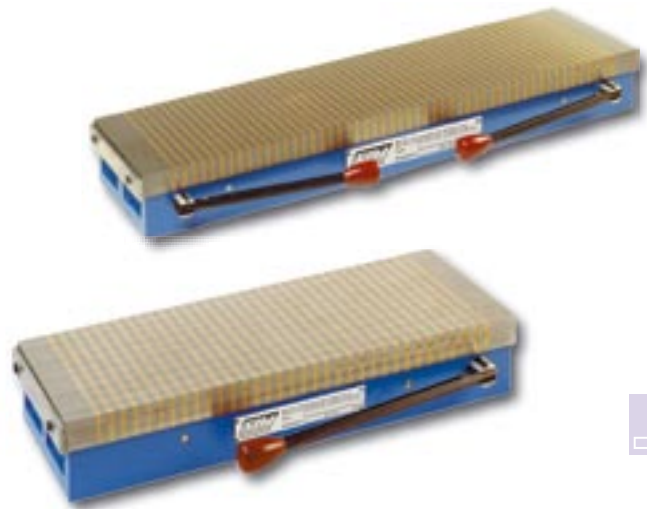

Dimensions in mm					Number of levers	Weight in kg
A	B	C ^{+0,5} ₋₂	D	F		
450	200	93	445	20	1	45.0
500	200	93	495	20	1	50.0
600	200	93	595	20	1	62.0
800	200	93	795	20	2	82.0
450	250	93	445	20	1	47.0
500	250	93	495	20	1	64.0
600	250	93	595	20	1	78.0
750	250	93	745	20	2	97.0
1000	250	93	945	20	2	129.0
400	300	93	395	20	1	72.0
500	300	93	495	20	1	90.0
600	300	93	595	20	1	100.0
800	300	93	795	20	2	130.0
900	300	93	895	20	2	153.0
1000	300	93	995	20	2	180.0

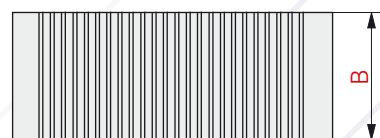
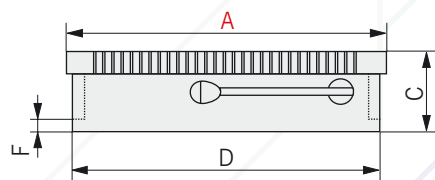

Ordering example: Permanent Magnetic Chuck SAV 243.12 - 600 x 300
Ordering key: Name SAV - No. - A x B