

## Permanent Magnetic Beam

SAV 243.15

With 2 magnetic faces

**Use:**

As a clamping device for holding workpieces securely on spark erosion (EDM) machines and other machining applications, or as part of a fixture.

**Features:**

Two clamping surfaces on opposite faces, individually switchable. Low magnetic field due to fine pole pitch. Supplied in pairs.

- Planar parallelism: 0.02 mm
- Pole pitch: 1.3 mm
- Magnetic field height: 6 mm
- Pole plate wearing limit: 6 mm

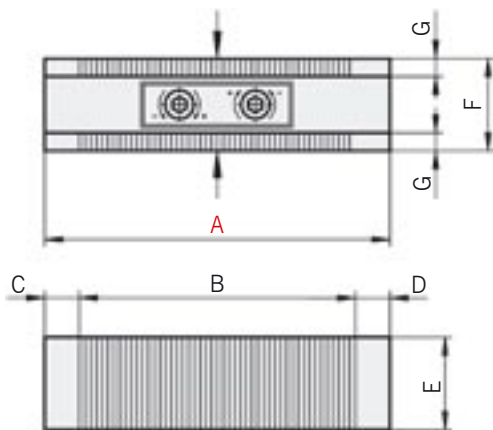
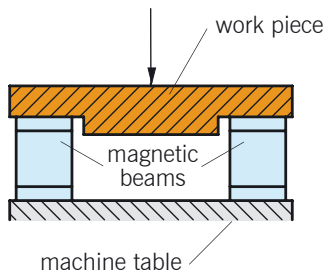
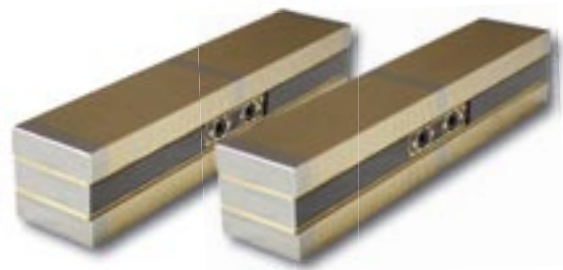

2 magnetic clamping surfaces

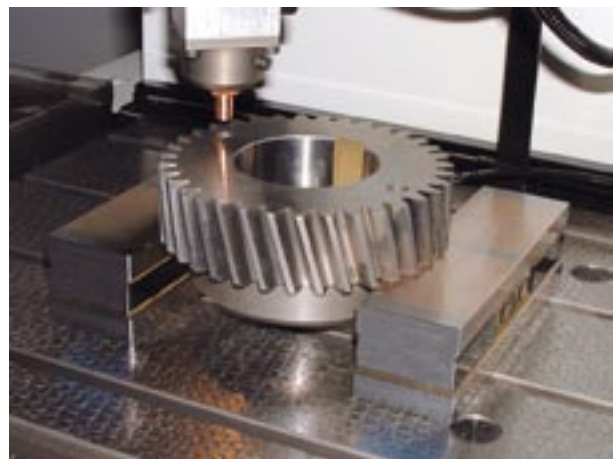

Dimensions in mm								Nom. holding force in N	Weight in kg
A	B	C	D	E	F	G	H		
125	98	13.5	13.5	52	50	15	7	300	2.5
180	153	13.5	13.5	52	50	15	11	400	3.6
250	225	12.5	12.5	52	50	15	11	590	5.0

Ordering example: Permanent Magnetic Beam SAV 243.15 - 125  
 Ordering key: Name SAV - No. - A